

# GGU

**ENGLISH:** Directions for use

**VELUX®**

## Important!

These directions for use apply only to roof windows with a "K" in the size code on the data plate.

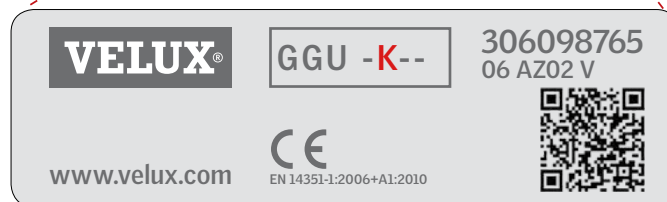
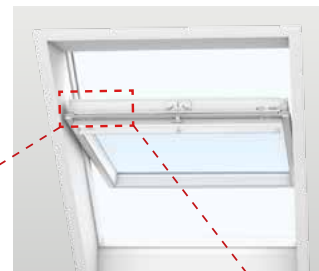

## Use of the ventilation flap

To enjoy fresh air even when the window is fully closed, pull the control bar lightly downwards to open the ventilation flap. The window will remain locked, but air can enter the room through a built-in air filter that keeps out dust, insects and drifting snow.



## Opening and closing the window

Pull the control bar once more to open the window. Friction springs in the hinges allow the sash to be parked in partially open positions. The window is closed by pushing upwards firmly on the control bar to lock the sash and close the ventilation flap.



## Ventilation position

The built-in barrel bolt allows you to fix the window in an open position. The barrel bolt is placed in the top right part of the window, and slides into the bushing at the top of the side frame.



## Cleaning the pane

To clean the outer pane, rotate the sash 180 degrees. The sash must be secured in position by sliding the barrel bolt into the bushing at the bottom of the side frame. This safety feature leaves both hands free for cleaning.

Clean the pane with a soft, clean, lint-free cloth/chamois leather/non-abrasive sponge or a clean, non-metal window squeegee. Clean water will normally be sufficient for cleaning the pane. Ordinary, non-abrasive household cleaners can also be used.

### Warning

- Avoid contact from silicone with the pane.
- Do not use any cleaning products containing abrasive particles.
- Do not use household cleaners containing high levels of acid or alkaline for cleaning the pane.
- Avoid contact with the pane from all sharp or abrasive objects including jewellery.
- Never attempt to clean off dirt on the pane without first applying water.
- If any works are taking place in the vicinity of the pane, protect the pane with a clean plastic sheet to prevent any splashes or staining from aggressive and abrasive compounds.

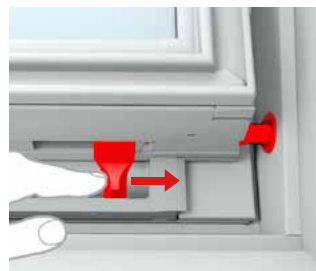

## Minimising condensation

Particularly in rooms with high levels of humidity, condensation can form on the inner pane of the window. This can be minimised by fitting a radiator directly below the window and by airing the room frequently.

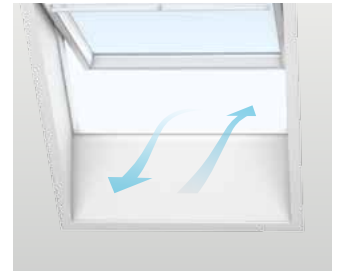
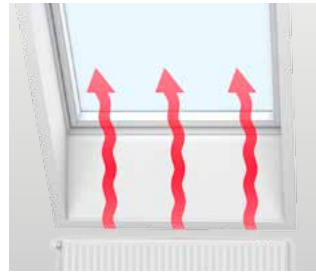

## Cleaning the air filter

The air filter can be removed and washed with ordinary household cleaners. Fully rotate and secure the window in cleaning position, then remove the filter from the filter rail. (New filters are available from your VELUX sales company).

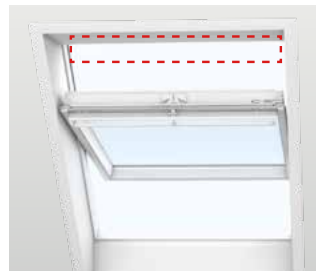

## Cleaning the window

The white polyurethane surface can be cleaned with ordinary household cleaners.



## Cleaning the flashing

Leaves and other debris should be removed from the flashing around the window to allow rainwater to flow freely.



## Snow and ice

It is important to make sure that water can always drain off from the window and surrounding gutters. Snow and ice should therefore be removed from the area on and around the window in the same way as leaves and other debris should be removed from flashing and gutters to allow melt water to flow freely.

